



i-LÉD





# **INK** **system**





# Evolution and revolution!

"A clean, precise sign of black ink. It may seem little; it actually becomes revolutionary when it conveys meaning, something much more important than the sign itself: a concept. That simple sketch is the essence of communication. If plotted logically, the ink transmits a message. If traced with grace, it embellishes the space and increases the value and the preciousness of the sheet as well as of what is written on it, whether it is an inscription or a drawing. INK System represents an evolution and at the same time a revolution in the lighting panorama: it revises the concept of a luminaire, disassembles it and reassembles it until it discovers

new alphabets. Starting with no less than a simple rubber conductor cable: the light becomes a reworked stretch, a continuous strip with indirect emission suspended a short distance from the ceiling; the same components, combined with the special extruded wall/ceiling lamp, become luminous paths that furnish the rooms and serve as the basis for the "letters" that will make up the system: spotlights, linear profiles and suspension lamps from the same family of products.

INK System is light, communication, furnishing element, interchangeability. It's evolution and revolution.

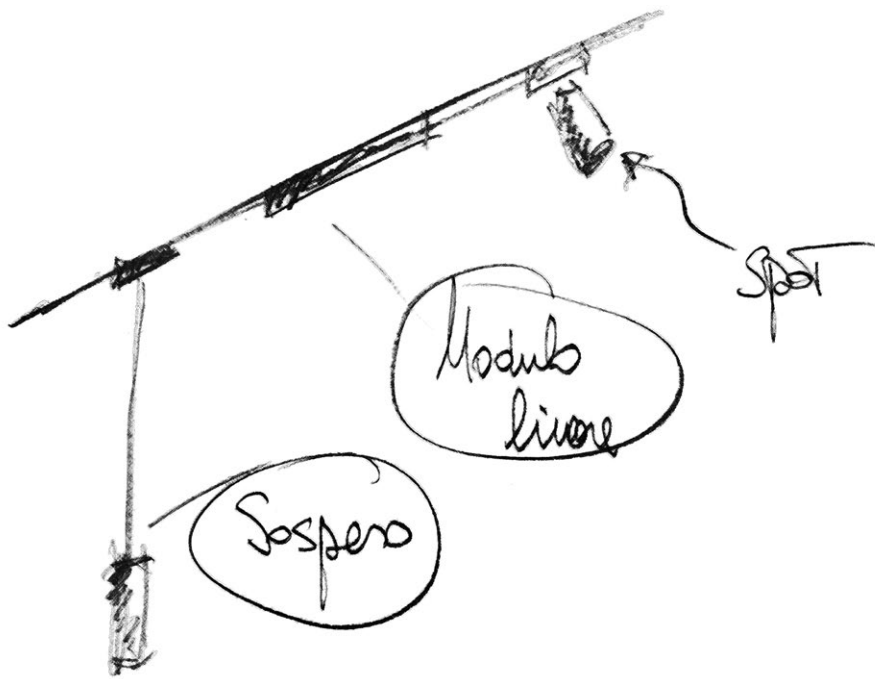

# Designed to adapt to any architectural situation

"Entirely designed and manufactured in Italy, INK is the perfect solution to overcome all the problems caused by pre-existing incomplete electrical systems or environmental limitations: cramped spaces, valuable materials not affected, lack of an adequate number of light points, up to the impossibility of installing drivers remotely.

In a nutshell: maximum versatility, in any surface and in any environment, even those with considerable installation limits.

INK is not a single lamp declined in multiple versions, but a system that includes multiple items that share the same concept.

The flexible and thin cable, in a stretched version, is perfect for illuminating important arches, beamed and ceilings of value, thanks to the high performance stripLED. The same cable acts as a conductor on which it is possible to hook the various compatible devices, allowing the adoption of various lighting solutions

even in environments where it is not possible to have light sources on the ceiling. Furthermore, the range includes real wall/ceiling paths: extruded modular units with various fittings house the conductor cable. This becomes a graphic sign that furnishes, but also an extended system that can unfold along and across the various environments, all starting from a single point of light.



# You can always change

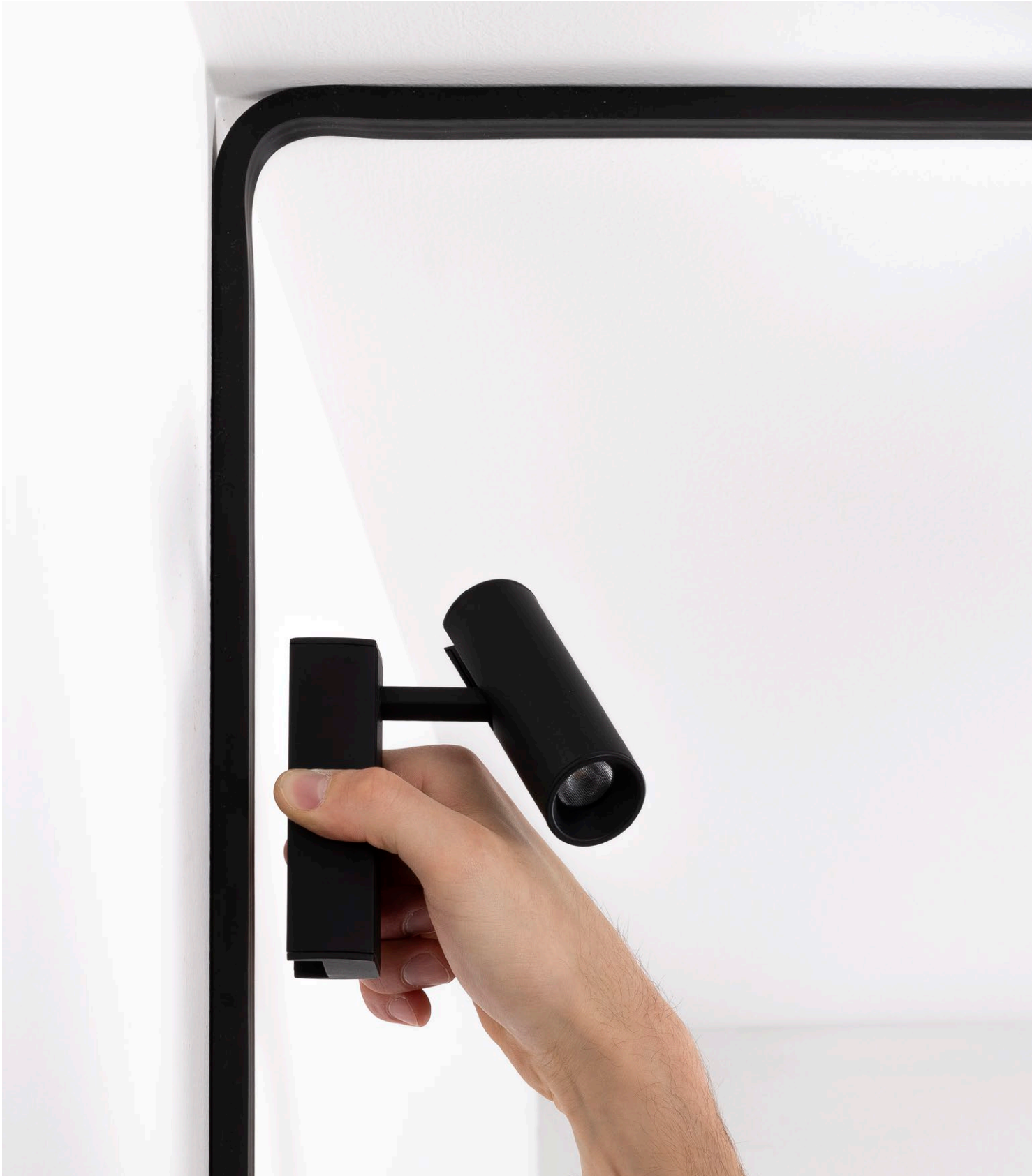



"Light profiles and linear suspensions with diffused emission or UGR controlled by special darklight cells, adjustable spotlights with three different optics and spot suspensions. The INK range includes many luminous articles with an ultra-fast coupling system to the rubber cable: just choose the preferred position, fix the luminaire by light pressure and

screw in the safety dowels with the special Allen key supplied. The cable acts as a safe and reliable conductor does not require any special protection or installation measures and allows maximum freedom of positioning. Changing is very easy: just unscrew the hex screws, remove the item and move it as you like!



# Stretching system

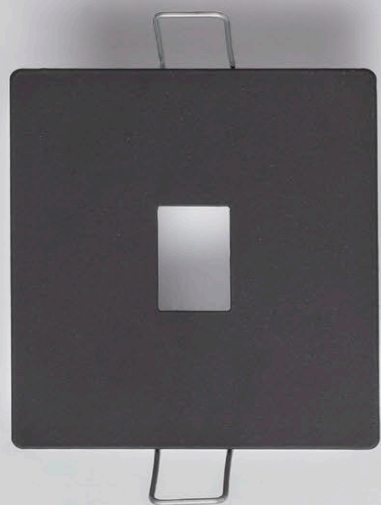
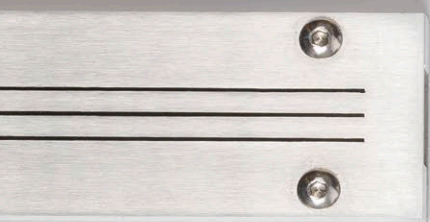
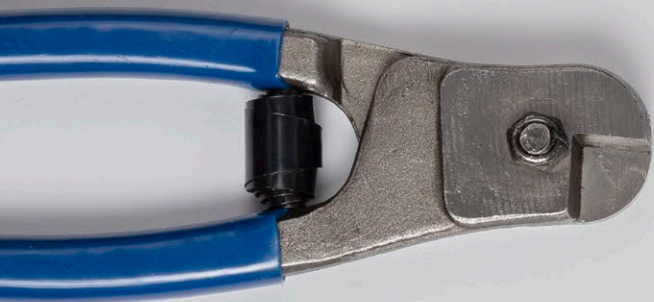

"The INK System allows avoiding the installation limits due to the impossibility to have a light point on the ceiling, due to the lack of systems and corrugated lines or to the presence of valuable materials or not-corrodible structures, such as beams, barrel vaults or cross vaults, historical ceilings.

The two articulated fasteners allow the cable to be stretched and connected to the wall in an aesthetically pleasing way, taking advantage of an existing light point placed at the desired height or going to prepare a power supply system that provides for a remote installation (from the socket box 503, p.22) or through an external driver (p.23). The range includes special covers for installation on plasterboard (p.14). The conductor cable, adjustable and tiltable up to 45°, can accommodate a stripLED for indirect

lighting and/or act as a simple support for the installation of lighting modules (p.24). If several modules are to be connected, the total weight of the modules and the resulting loosening of the cable tension must be taken into account. To overcome the problem and keep the cable tensioned, it will be necessary to use one or more steel supports.

**WARNING:** To determine the correct length of the cable (including the waste to be expected during cutting), the maximum number of modules that can be hooked up and the number of steel supports to be used, you must contact the Linea Light Group Lighting Department. Linea Light Group is not liable for any malfunctions or errors due to do-it-yourself installations (strongly discouraged).

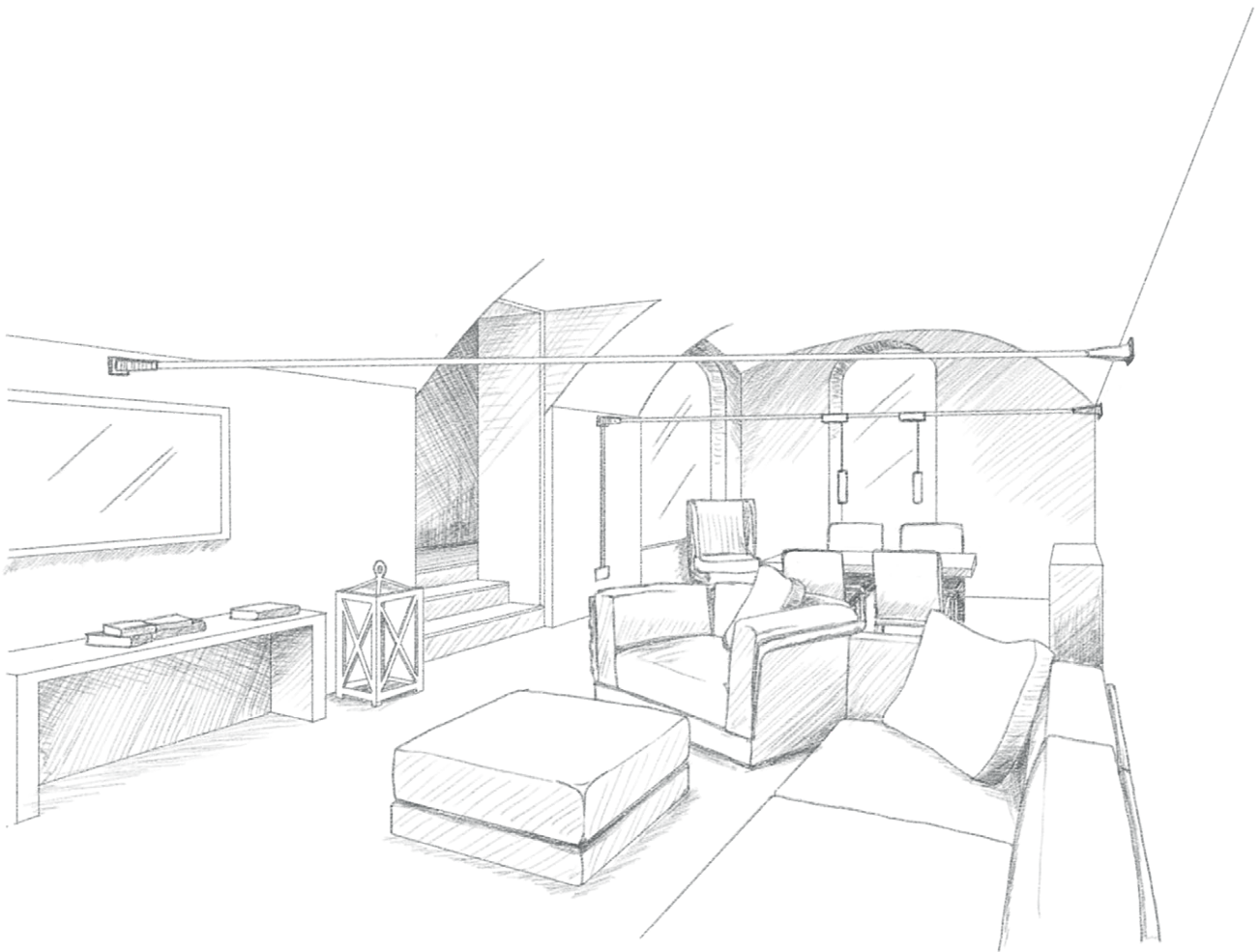

## The stretching system includes:

- Cable
- Cable cutter kit (cable cutter template + cutter + cutting pliers)
- LED strip
- Articulated wall mounting
- Plasterboard cover
- Supporting steel cable

- Power supply modes (p.20)
- Lighting modules (p.24)

## Cutting the cable

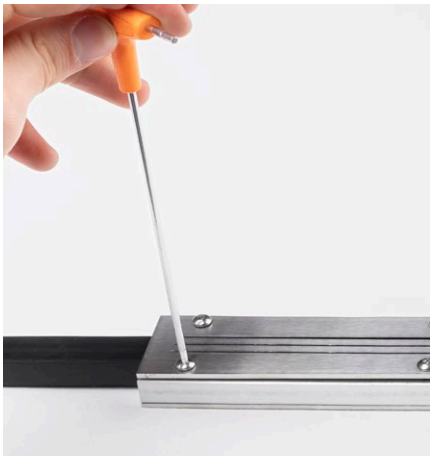

Use the cable cutter kit **81427** to prepare the cable for wall mounting and wiring. Loosen the screws with an Allen key, insert the end of the cable to be cut and close the screws. Make sure that the cable is firmly fixed inside the template.



Proceed with the various cuts following the appropriate slots and acting vigorously with the extremity of the cutter blade. Once finished, pull out the cable now divided into four

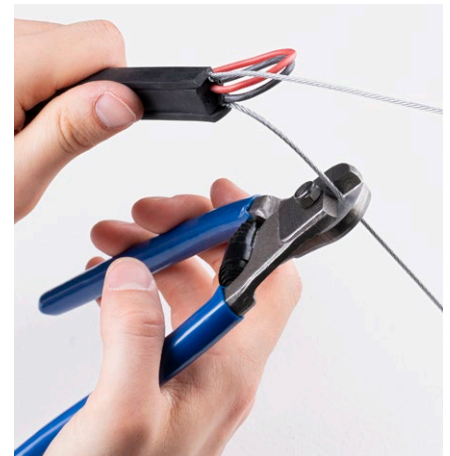

Strip off any excess rubber parts until the two steel cables, and the two red and black power cables are released. At this point, proceed with the cutting of the excess steel cables using the supplied cutting pliers.

## Fixing the bracket



Remove the cover from the base of the bracket **81423** and proceed with the wall fixing, using the screws and plugs provided and following the installation holes at the corners. Route the wall-prepared power cables through the two openings to facilitate subsequent wiring.

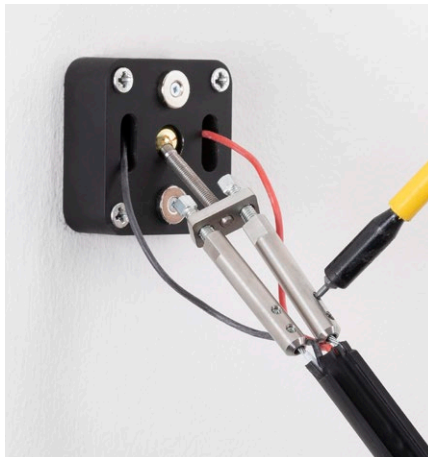

Insert the rubber cable into the cover, now without the bracket. At this point, fix the steel cables in the appropriate ends of the bracket, working on the dowels with the Allen key provided, and proceed with the wiring as indicated in the instruction sheet.

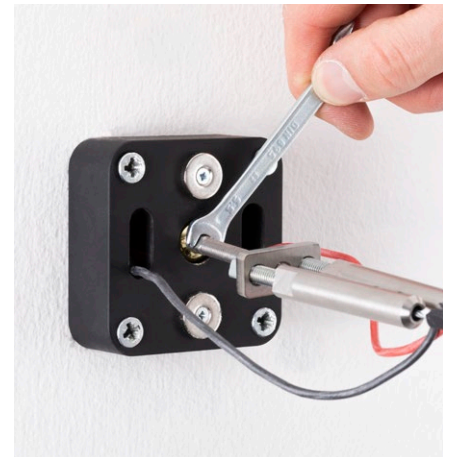

Once both brackets have been fixed to the opposite sides of the room, tighten the cable using a key on the appropriate adjustable elements, two for each bracket, indicated in the instruction sheet. Move both brackets gradually until the maximum tension is reached.



Unroll the roll, insert the LED strip and secure the end at the beginning of the cable with light pressure. Make sure the pins are properly inserted into the rubber.



Then insert the strip into the housing by pressing with your thumb and following the entire length of the cable as you go along.



The stretching can be rotated by 360° (proceeding in intermediate steps of 90°). To do this, uncover the fixing bracket by removing the cover, rotate the cable and the ends to which it is attached and, once the desired inclination has been reached, close the cover.

## Orientation of the stretching

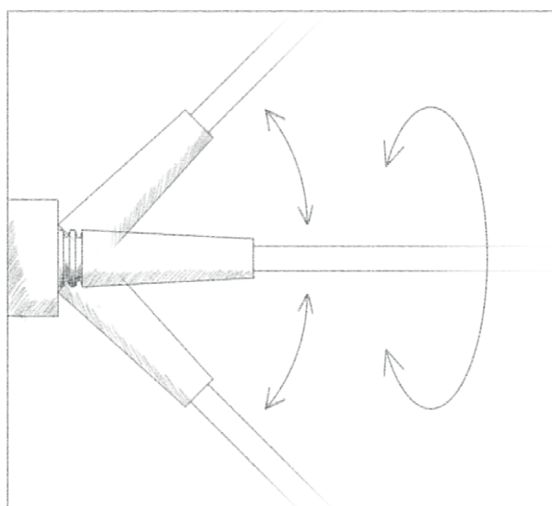

Side view

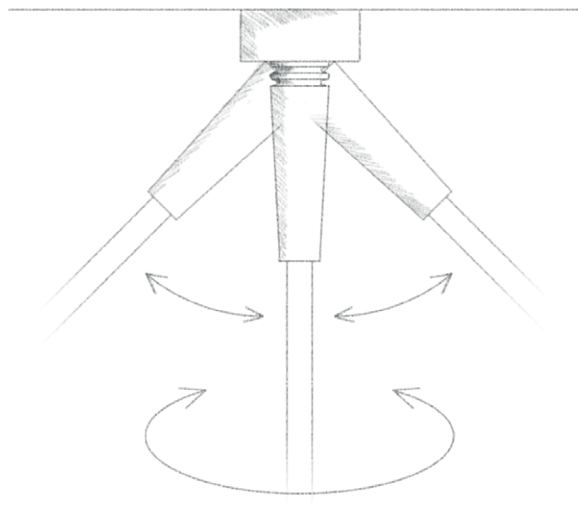

Top view

"Thanks to the articulated rubber covering of the roof and the spherical pin that hooks the fixing elements to the base of the bracket, the cable moves 360° degrees around its fulcrum in all directions, vertically, horizontally or diagonally, reaching a maximum inclination of 45°.

A solution that makes INK perfect for homogeneously illuminating beamed and tilted vaults, adapting to the architectural lines of the structure and providing exactly the same degree of illumination at every point of the ceiling.

## Stretching on plasterboard

"The INK System provides the possibility of opting for installation on plasterboard thanks to the appropriate covers **81422**.

Basic requirement: the cable must be installed on masonry behind the plasterboard using a **81423** bracket. The designer must provide two 81422 covers for each plasterboard wall, which must be inserted into the cable before fixing; afterwards, once installed and under tension, create the dummy plasterboard wall (min. thickness 10 cm - max. 25 cm) and position the spring-loaded covers in the cable entry and exit holes.

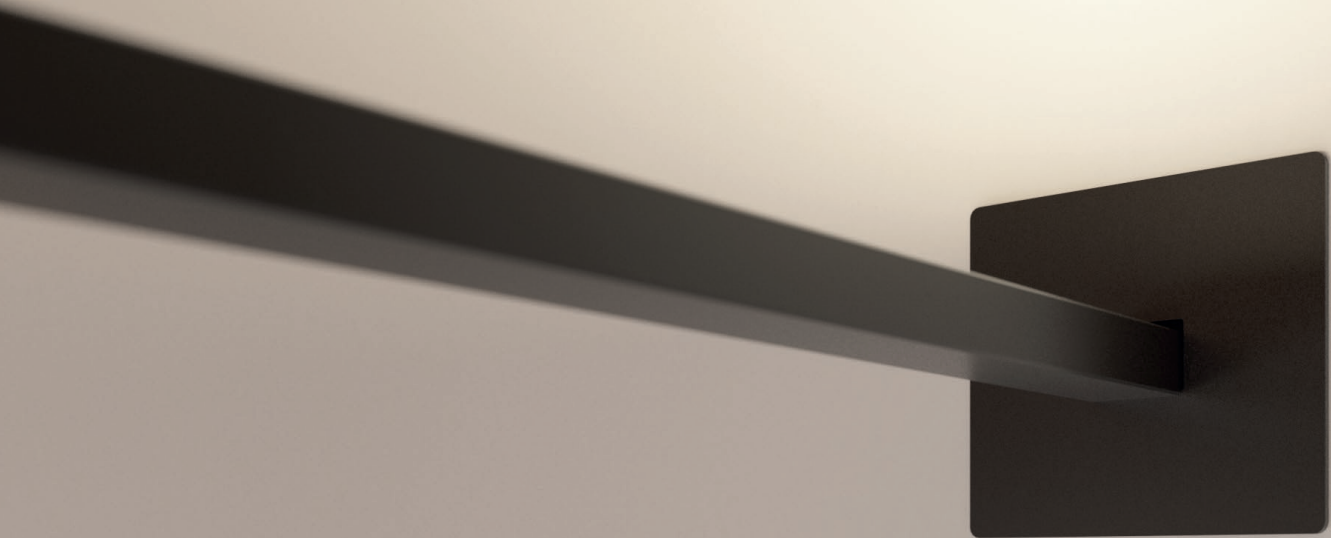
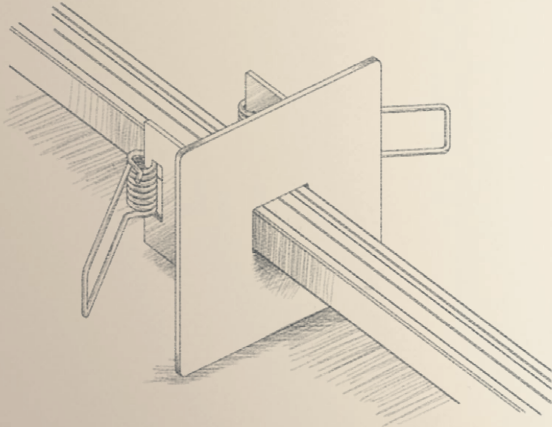

## Stretching on masonry with decentralised light point



The cover of the **81423** fixing bracket has three openings, originally closed but cuttable and detachable, arranged along three sides. Once the wall/ceiling path from power source has been prepared (p.20), it is necessary to connect it to the bracket by cutting the opening we are interested in and opening it with the help of a clamp.

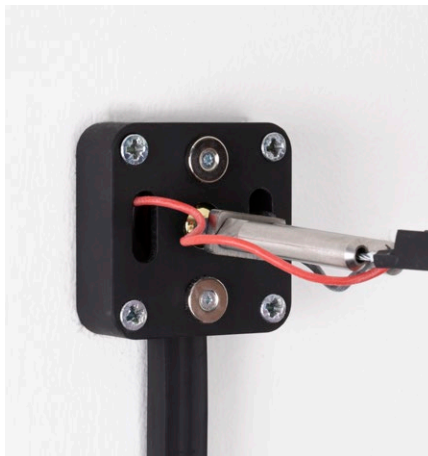

Fix the base of the bracket at the end of the cable, then proceed with the wiring and fixing of the steel cables.



Continue as usual until the procedure is complete.

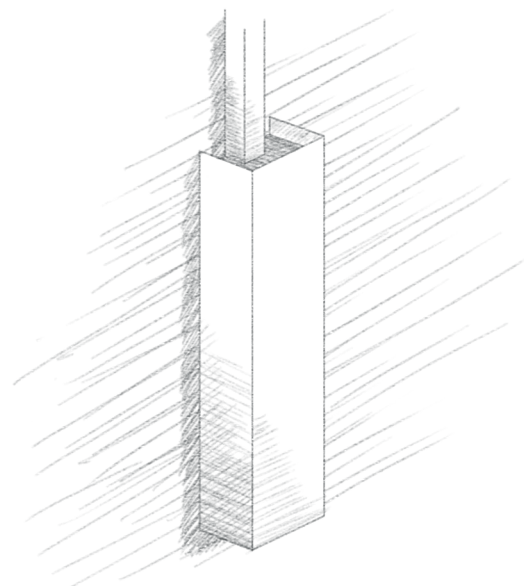
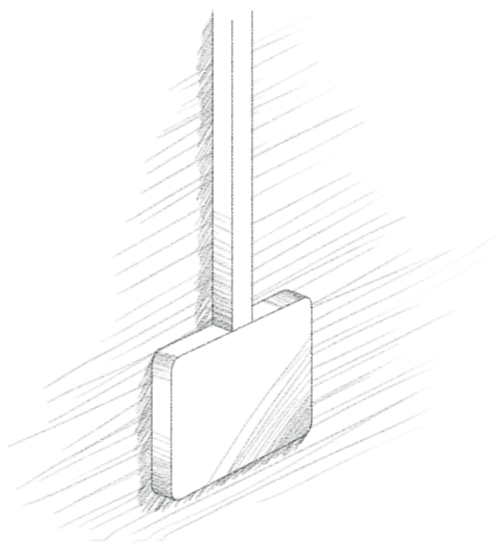

“Thanks to the versatility of the INK System, it is possible to feed the stretching product using the existing predispositions, even if decentralised or spaced. For example, you can start from the 503 socket box (p.22) and continue along the wall up to the point where you want to position the fixing bracket of the stretching, feeding it remotely.

If you cannot use the remote driver, you can still use the existing light points thanks to the external driver with cover (p.23), continuing in the same way along the wall to the desired point.

## Wall/ceiling system





"The INK wall/ceiling system represents a praise for Design, allowing the creation of the most diverse lighting paths starting from a single light point, whether it be the 503 socket box (p.22) from which to prepare a remote system or a pre-existing corrugated to which to connect the external driver with a cover (p.23). The only limit is fantasy!

The elements available allow the composition of light paths with different deviations, branched systems that extend from room to room, or, you can give rise to more discreet installations that focus on the furniture component to connote the rooms with minimalist lines dry and clean. Arranging the extruded products according to a pre-established path on which to insert the rubber strip, it is possible to create a black

line that, in addition to decorating the wall, acts as a conductor cable and allows the attachment of various lighting modules. Fittings close the corners and allow you to expand the path, while the flexible cable material makes it possible to create wall/ceiling or wall/wall corners without the aid of any joining accessories.

**WARNING:** the wall/ceiling system cannot be separated from the use of suitably arranged lighting modules. The support of the Linea Light Group Lighting Office is, therefore, necessary to develop a correct upstream lighting design, which takes into account the overall extension of the system, the number of items to be hooked up and the overall power absorbed.



## The wall/ceiling system includes:

- Cable
- Extruded
- L-connector
- T-connector
- X-connector
- Closing cap

- Power supply modes (p.20)
- Lighting modules (p.24)

## Change of direction (90 degree curve)

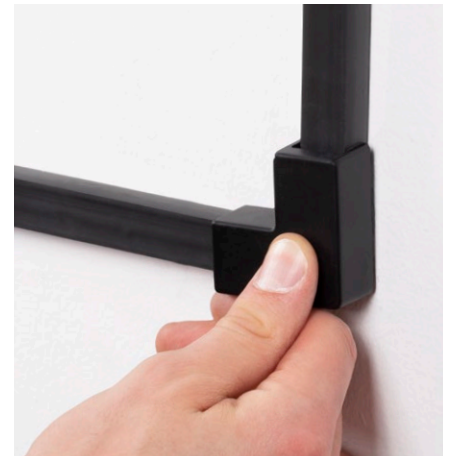

To create the path, fix the extruded material to the wall or ceiling. The system allows orthogonal direction changes, using the various fittings. To calculate the correct position and distance between one extruded product and the next, use the supplied template and place it laterally between the ends of the extruded products.

Once the extrusions have been arranged, position the cable sections properly cut. The rubber cable is then connected by inserting the hollow part into the extruded part, which acts as a rail. No accessories or fixing systems required. The cable can be removed just as easily as it can be inserted.

The connection is made by inserting the fitting: push the joint piece making sure that the pin plugs grip at both ends and fit correctly into the rubber.

## The entire INK System works with a pin-mount system



"The secret of INK's versatility lies in the ease with which it is possible to change the direction of the wall/ceiling paths and in the speed with which all the lighting modules can be connected. The "secret of the secret"? The pin connector, which uses the flexible rubber conductor cable. When the pins are

pierced by light pressure, they are supplied by the 24 V voltage of the cable. Once the piece has been removed, for example, to change the arrangement of the accessories, only imperceptible marks remain on the cable, practically invisible to the naked eye thanks to the very small size of the pins.

## Angle wall/ceiling or wall/wall

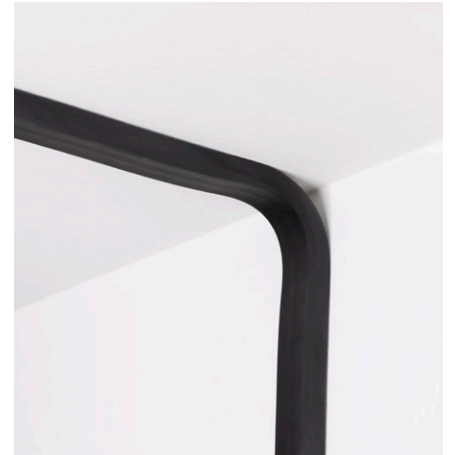
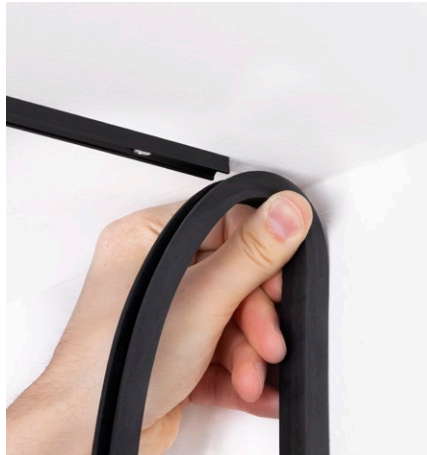

INK System allows the continuation of light paths on different levels, with the possibility of connecting wall and ceiling or two contiguous walls. To do so, fix the two extrusions while maintaining a distance from the angle of 4cm.

Insert the rubber cable as per procedure, pressing on the strip until the hollow part along the extruded track is inserted.

Follow the natural inclination of the strip along the corner and continue with the insertion of the cable. The flexible material allows you to create an angle easily and safely, without having to cut or break the cable.

## Cable fixing to wall/ceiling

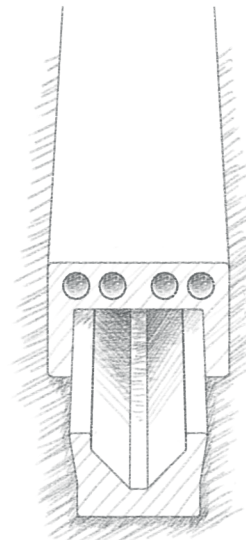
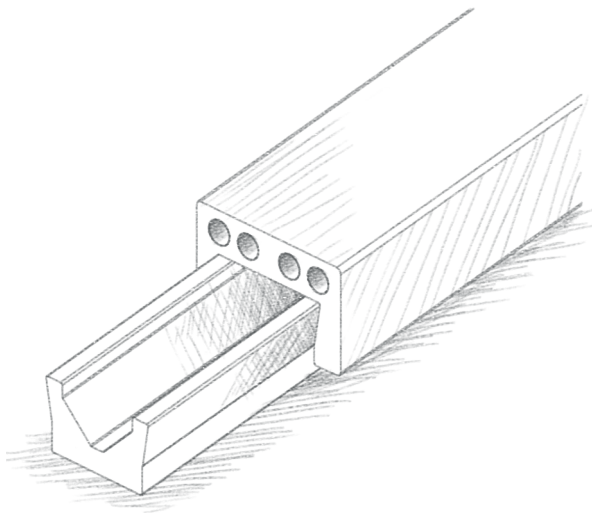

"The conductor cable can be fixed to the wall or ceiling using an extruded metal cable. Length 1 m, available in kits of 2 (**81430**) or 5 pieces (**81426**), the extruded part must be fixed with screws and plugs, using a spirit level or a laser. If necessary, it can be cut with a rotary cutter to obtain a shorter size. Fixing several pieces in series creates the path along which to hook the conductor cable.

The extruded material acts as a guide, into which the part of the rubber strip is inserted applying slight pressure. As you proceed, the whole cable is inserted until the end of the line. Very easy to insert, very easy to remove if necessary: just remove the rubber cable from the extruded material. The same cable can then be reused and reinserted.

# Power supply mode



"INK is a versatile system in the true sense of the word, not only because of the wide range of possible configurations and accessories available but also because of the many power supply options. A plus that makes a difference: INK is a multitasking system also (or above all) because it allows the designer to feed the entire structure from a single point, and to choose which one. Incredible facilitation if we consider all those environments with pre-existing electrical systems, not to mention the architectural and construction constraints that may exist especially in buildings recovered through renovation. Isn't it possible to create new systems tailored to the lighting design?"

No problem: installing INK only requires the presence of a single light point, located anywhere in the surrounding area, from which to start.

Usually, in an environment, there are several light points. From socket boxes, located at ground level or at medium height, to corrugated boxes generally suitable for wall lamps or ceiling/hanging lamps.

Whether you can build a system remotely or not, the INK range provides appropriate solutions for each case, adapting to any installation situation. That is a concretely versatile system.

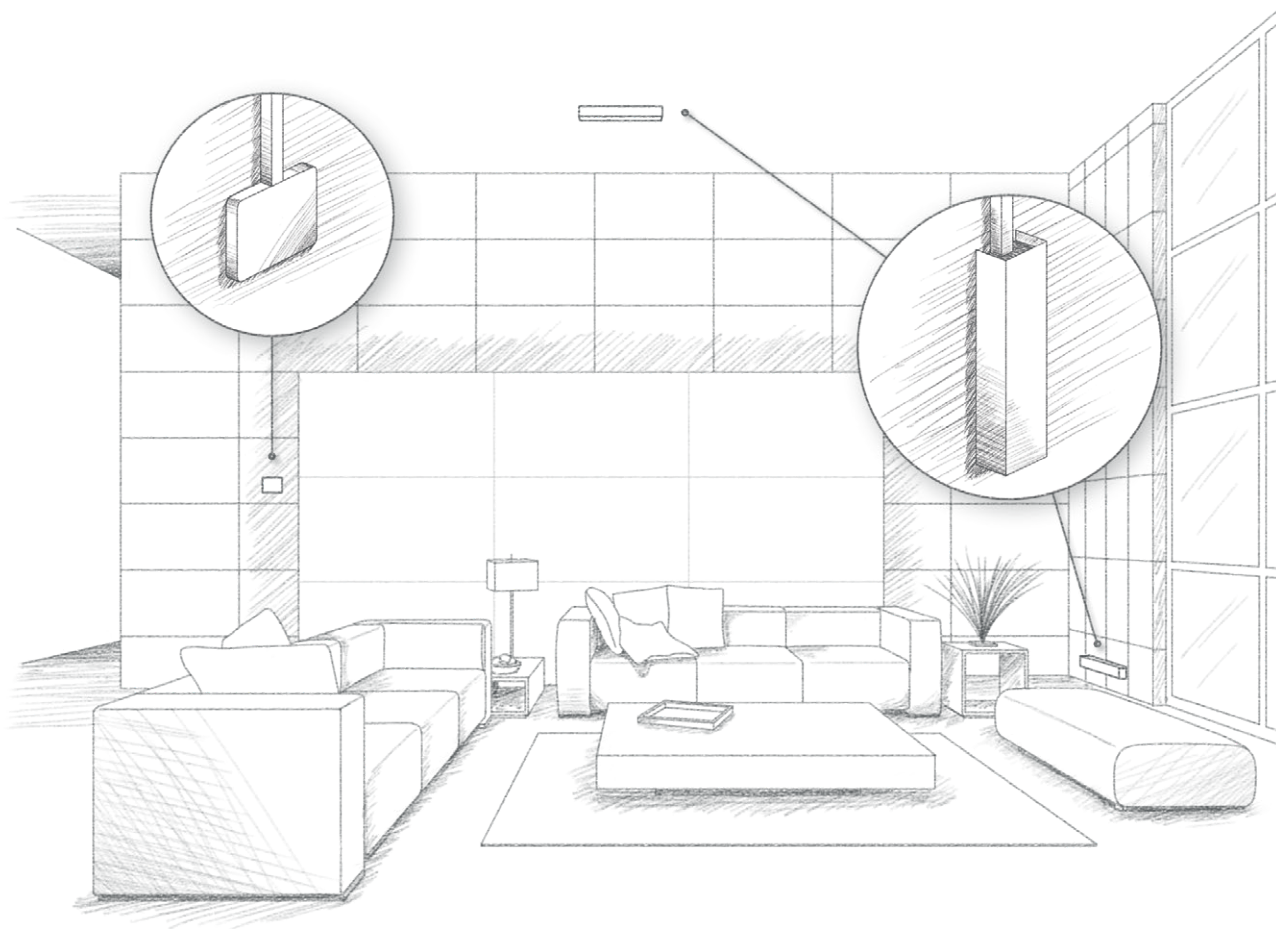

## The range includes:

- Remote ON/OFF driver
- Junction box with cover
- ON/OFF driver with cover

Remote dimmable driver (Maestro catalogue 2.0 p.982-984)

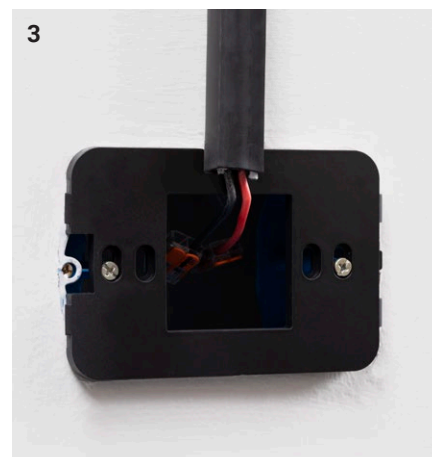
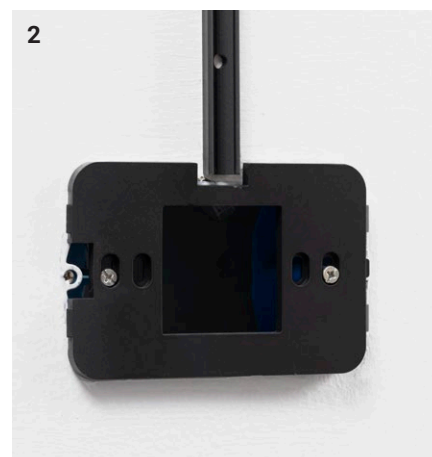
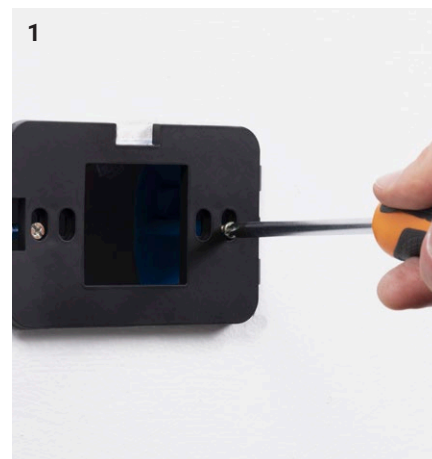

## Remote driver with junction box

"INK conceives the possibility of using the 503 flush mounted socket box as a starting point for powering the entire system, going to position the driver remotely directly in the electrical panel or, more generally, wherever the system and space available allow it. You can choose the 120 W (**81416**) or 180 W (**81417**) remote ON/OFF driver or choose one of the dimmable drivers offered in the i-LèD Maestro 2.0 catalogue

.Once the driver has been positioned and the system and its wiring set up, it is possible to proceed with the installation of the various system components, starting from the junction box **81424**.

**1)** Remove the cover from the base and proceed with the installation of the base in correspondence with box 503, using the screws and dowels supplied. The dimensions of the base are perfectly compatible with the opening of the recessed socket box.

**2)** Install the starting extrudate on the wall so that the end is in correspondence of one of the two compartments, positioned respectively on the long and short sides of the rectangular base. It is possi-

ble to choose only one: therefore, before proceeding, it is necessary to have clearly defined the path that the system will have to cover.

**3)** When the route is complete, cut the cable to the desired length and insert it into the guide, proceeding with the wiring as indicated in the instruction sheet.

**4)** The lid has two openings, originally closed but cuttable and detachable with the help of scissors and pliers. Release the opening corresponding to the starting point of the cable and close the junction box again.



## Driver with cover

"When the environment, due to lack of space, does not allow the positioning of a driver remotely, it becomes necessary to opt for an exposed power supply to be connected to a light point. An option that represents the only way forward in the presence of structures with already existing systems and not modifiable, which do not provide hidden housings for the power supply of the system. This is a limit that the INK range remedies with the appropriate external 120 W (81413) or 180 W (81414) driver. The driver is housed inside an elegant cover that completely covers it, combining excellent protection with refined and pleasant aesthetics. With its small dimensions, the rigorous shape takes up the linearity of the system, guaranteeing the spatial continuity of the cable. Once you have identified the wall or ceiling corrugated from which the electrical cables to connect are coming out, you can proceed with the installation of the various components of the system, starting from the driver with cover 81413 / 81414.

**1)** Install the base at the corrugated area using the screws and dowels supplied, taking care to run the electrical cables through the hole provided.

**2)** Proceed with the wiring, as indicated in the instruction sheet. Install the starting extrudate so that the end is at the side hole.

**Double output option:** the driver 81413 120 W has two side openings, possibly with the possibility of starting two simultaneous paths, one for each side.

**3)** Complete the installation with the insertion of the rubber cable (suitably cut), make the electrical connection with the driver and close it all with the appropriate cover.

**Double output option:** The driver cover 81413 120 W has an open hole and a closed hole on the opposite side; if you want to make a double path simultaneously, open the hole by unscrewing the appropriate closing nuts.



## Lighting modules

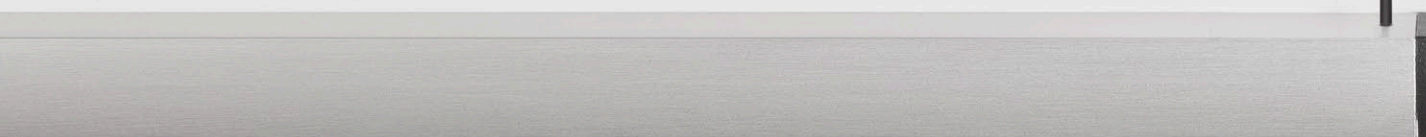
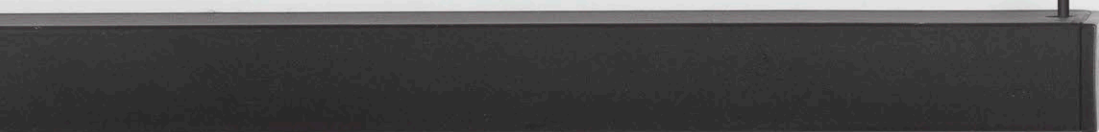





"The range of lighting modules provided by INK System is wide and varied. Each item is modular because it is designed both for series installations along the cable and for single installations that are always interchangeable. The ease with which it is possible to change the configuration of the elements, replacing them or changing their position, is the real plus of the INK System. The entire length of the conductor cable can be used as a fastening point for spotlights, suspensions and linear modules, on the ceiling or on the wall, without limits to creativity: just choose the article, insert it into the cable, and you're done!

INK System allows you to choose from many proposals, which can be combined with any context: compact and discreet projectors, small in size but powerful and versatile, with three different optics; flood suspensions, perfect for point lighting of flat surfaces and details; suspensions and linear modules of various lengths, more suitable for flat surfaces

and extended the former, designed for walkways (but also shelves and display contexts) and the latter. Both types allow you to choose between two different optics: diffused, for soft and extended general lighting; UGR controlled, thanks to the darklight accessory installed in the optic that sections the beam drastically reducing the glare near the source. A perfect solution for environments that require intensive use of monitors and displays, for example, in the office environment. All the proposals are available in two different finishes, matt black and anodised aluminium.

**WARNING:** Each lighting module requires a specific power consumption. You can place multiple items on the same cable. However, the maximum number of products that can be connected depends on the type of products and the overall length of the cable. In the case of complex lighting projects, in order to avoid overloading the cable, it is recommended to use the support of the Linea Light Group Lighting Department.

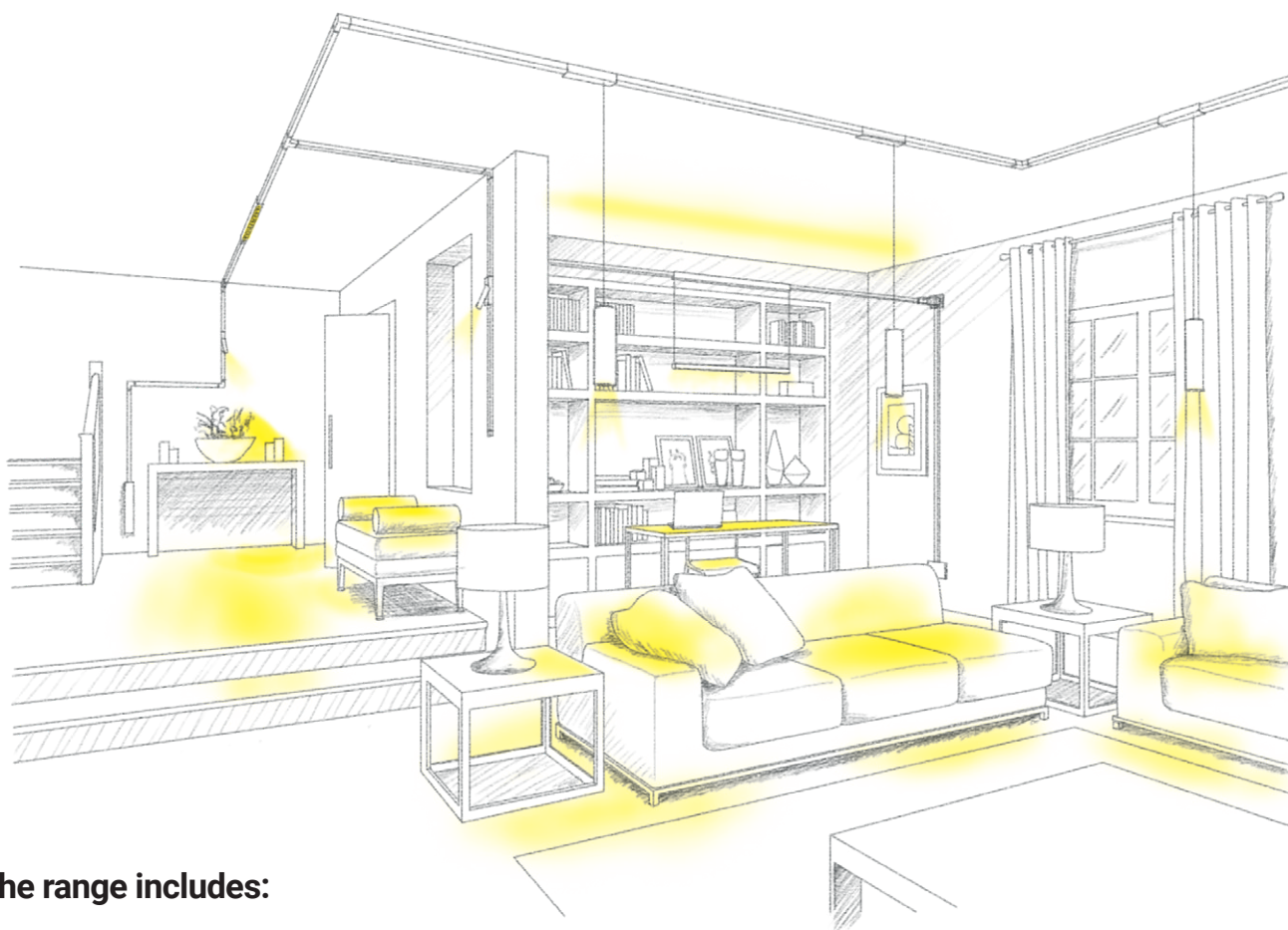

## The range includes:

- Linear module with diffuse optics
- Linear anti-glaring module
- Linear suspension with diffuse optics
- Linear anti-glaring suspension
- Flood suspension
- Projector

## Lighting modules installation and features

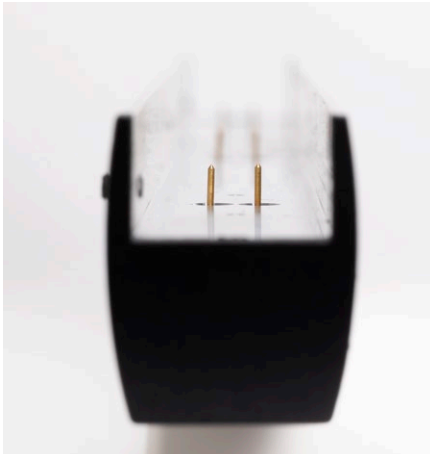

The pin plugs fit into the conductor cable, powering the light module once the minimum depth is reached. When the article is removed, the cable is intact and aesthetically unaltered: the microscopic marks are practically invisible, thanks to the very small size of the pins.



Hooking the light module is a quick and easy operation: just press it down so that the pins are inserted into the rubber cable. It is important to push while maintaining a direction perpendicular to the cable, keeping the article straight and aligned to prevent the pins from sticking or bending

incorrectly. DO NOT tilt the article during hooking or removal. Each item has a precise polarity and, therefore, only one direction of installation.



Once the module has been completely inserted into the cable, proceed with the safety fastening, working on the dowels at the ends with the Allen key provided.

**IMPORTANT:** the installation is completed only after the safety fastening is completed; vice-versa, the fastening can loosen under the weight of the article, which risks switching off or detaching and falling.



The lamp body of the projector module can be easily unscrewed: the article, in fact, provides the possibility to modify the emission by inserting in the optical compartment of an accessory honeycomb filter, included in the package. The honeycomb screen dramatically reduces glare, increasing visual comfort.



All modules are made of aluminium, for better heat dissipation, combined with high quality plastic joints. Available in two finishes, both with attention to detail: matt black RAL 9005, with a strong character; and anodised aluminium, elegant and refined thanks to the shine of the material and the characteristic streaks, combined with the black of the closing elements for a refined two-tone effect.

# Ceiling mounted coffered system

## Location

Renovated residential property.  
The sleeping area has a large coffered ceiling of particular value.

## Lighting solution

The absence of light points and the need to preserve the integrity of the ceiling make it impossible to install pendant or ceiling lamps. The adoption of a system with several ballasts connected to a single power supply with a double output cover allows indirect ambient lighting and at the same time allows the ceiling to be enhanced. The general lighting is supplemented by the insertion of projectors + suspensions in the vicinity of the tables.

- 01) Driver ON/OFF with cover 120 W cod. **81413**
- 02) Extruded ceiling wall cod. **81426** + cable 5+1m cod. **81410**
- 03) Articulated wall mounting cod. **81423**
- 04) Cable 5+1m cod. **81410** + LED Strip Hi-Flux 5m cod. **81409W00**
- 05) INK system\_SP | Projector cod. **81389W45**
- 06) INK system\_P | Suspension cod. **81396W45**







05

04

06

03

01

02

# Stretching system on reception desks

## Location

Reception on a high ceiling glassed environment. Reception desks not contiguous and separated by a central dividing element.

## Lighting solution

The absence of light points on the ceiling and the high height of the room make it impractical to install pendant or ceiling lamps. The large windows provide good ambient lighting but are not sufficient to provide 500 lx of light on both reception desks. The imposing central partition is another disturbing element in terms of lighting technology. To solve the problem, we chose to adopt a system with two stretching (not illuminated) remote powered systems. Both are fitted with anti-glaring linear suspensions that illuminate the reception desks, guaranteeing the right illuminance and optimal visual comfort.

**01)** Driver ON/OFF remote 120 W cod. **81416** + junction box cod. **81424**

**02)** T-connector cod. **81420**

**03)** Extruded wall/ceiling lamp cod. **81426** + cable 5+1m cod. **81410**

**04)** Articulated wall mounting cod. **81423**

**05)** Cable 5+1m cod. **81410**

**06)** INK system\_LP UGR | Linear suspension anti-glaring 1200mm cod. **81404W30**



# Wall/ceiling system on a dining room





### Location

Open space room in modern residential context. The environment includes a dining table and top with sink.

### Lighting solution

The versatility of the INK system allows you to light a large dining room full of elements without affecting the integrity of the ceiling or providing an excessive number of lighting points. The remotely powered path starts from the 503 wall mount, goes up to the ceiling and extends, allowing you to reach through the most suitable modules the main points of the room.

**01)** Driver ON/OFF remote 180 W cod. **81417** + junction box cod. **81424**

**02)** L-connector cod. **81419**

**03)** Extruded wall/ceiling lamp cod. **81426** + cable 10+1m cod. **81411**

**04)** INK system\_P | Suspension cod. **81396W45**

**05)** INK system\_SP | Projector cod. **81389W30**

**06)** INK system\_LP | Linear suspension anti-glaring 900mm cod. **81400W30**

**07)** Wall/ceiling cap cod. **81421**



# System on a diagonally beamed ceiling





#### Location

Renovated country house. Sleeping area with face-to-view brick wall and oblique beamed ceiling structure.

#### Lighting solution

Walls with exposed bricks and beamed ceilings require effective but discreet lighting, especially at night. The INK tensioned systems allow to reach the desired inclination (max 45 degrees) to adapt to the ceiling, indirectly illuminating it. At the same time, the cables serve as a basis for the addition of headlamps and suspensions that integrate ambient lighting at places where more light is needed. The driver with cover allows you to power the systems while preserving the integrity of the wall and avoiding the need to make grooves

for ad hoc systems. To maintain stylistic continuity, INK is also available in the wall system with headlamps.

- 01)** Articulated wall mounting cod. **81423**
- 02)** Cable 5+1m cod. **81410** + LED Strip Basic 2.5m **81406W00**
- 03)** INK system\_SP | Projector **81390W45**
- 04)** INK system\_P | Suspension cod. **81396W45**
- 05)** Extruded wall/ceiling lamp cod. **81426** + cable 5+1m cod. **81410**
- 06)** L-connector cod. **81419**
- 07)** Driver ON/OFF with cover 180 W cod. **81414**
- 08)** Wall/ceiling cap cod. **81421**
- 09)** INK system\_SP | Projector **81389W30**



# Wall system on a residential living area

## Location

Modern living room with a large ornamental wall.

## Lighting solution

INK adapts to architectural structures by helping to furnish, not just to light. In the most minimal environments, where symmetrical and rigorous ornamental elements are present, INK finds its perfect place even with a few pieces and simple compositions. The scenic impact is combined with the lighting engineering function, therefore the adoption of projectors with crossed beam to emphasise the paintings on the walls.

- 01) Driver ON/OFF remote 120 W cod. **81417** + junction box cod. **81424**
- 02) L-connector cod. **81419**
- 03) Extruded wall/ceiling lamp cod. **81426** + cable 5+1m cod. **81410**
- 04) INK system\_SP | Projector cod. **81389W45**
- 05) Wall/ceiling cap cod. **81421**

01



05

04

03

02

# Mixed system on temporary store

## Location

Temporary store in a central urban context.

## Lighting solution

The temporary store, a very popular sales solution, is often housed in architectural spaces where changes to the structure and systems are prohibited. It becomes necessary to adapt to the already existing conditions, a very heavy limit in the field of lighting technology. INK makes it possible to solve the problem thanks to the external power supply with cover, which can be connected to any light point, and to the stretching and wall/ceiling systems with which to exploit all the spaces, even the narrowest ones. In this way, it becomes possible to recover

underground and under the stairs, indirectly illuminate the environment without affecting the ceiling thanks to the textures and place at will suspensions and projectors along the route of the cable.

**01)** Extruded wall/ceiling cod. **81426** + cable 5+1m cod. **81410**

**02)** INK system\_SP | Projector **81390W45**

**03)** L-connector cod. **81419**

**04)** Cable 5+1m cod. **81410** + LED Strip Hi-Flux 2.5m **81408W00**

**05)** Articulated wall mounting cod. **81423**

**06)** INK system\_P | Suspension cod. **81395W45**





# Wall/ceiling system on the bar counter

## Location

Bar/cafeteria counter

## Lighting solution

To illuminate the entire counter, INK designs a ceiling system that follows exactly the same shape. Starting from the 503 socket box, the cable acts as a support for the attachment of three linear suspensions + a linear module with diffused emission, to illuminate the area of passage of the operators, and a projector pointing towards the wall blackboard.

01) Driver ON/OFF remote 120 W cod. **81416** + junction box cod. **81424**

02) Extruded ceiling wall cod. **81426** + cable 5+1m cod. **81410**

03) INK system\_LP | Linear suspension 900mm cod. **814398W00**

04) L-connector cod. **81419**

05) INK system\_L | Linear module 600mm cod. **81385W00**

06) INK system\_SP | Projector **81389W45**

07) Wall/ceiling cap cod. **81421**







# Stretching system in bar/restaurant



### Location

Main room tables bar/cafe/restaurant. A large portion of the vertical garden decorates the wall.

### Lighting solution

Combining localised lighting on tables arranged in series with a more general emphasis on decorative walls may require the use of numerous luminaires. Or, as in this case, the INK System taut cable, which acts as the only conductor for projectors and suspensions, is enough. The

modules can be repositioned or replaced at will, if necessary, when hooked up near the points to be illuminated.

**01)** Cable 10+1m cod. **81411**

**02)** Ink system\_SP | Projector cod. **81389W45**

**03)** Support cable cod. **81425**

**04)** Ink system\_P | Suspension cod. **81396W45**





# Mixed system in concept store

## Location

Concept store in existing building with masonry structure. Further space is obtained thanks to a partition wall in plasterboard. The addition of a false ceiling diversifies the heights.

## Lighting solution

In the vicinity of the masonry wall, the track system allows you to overcome the high height of the original structure, illuminating the arch and acting as a support to attach the spotlights. The taut cable passes through the plasterboard partition wall, and the special cover elegantly closes the passage hole. The path created in the false ceiling combines diffused light solutions designed for the walkway areas with others that have more localised emission; the versatility of the range and the use of multiple fittings allow the system to wind in critical points and install linear modules in the sub-shelf.

- 01) Plasterboard cover cod. **81422**
- 02) Cable 10+1m cod. **81411** + LED Strip Hi-Flux 5m cod. **81409W00**
- 03) Ink system\_P | Suspension cod. **81395W45**
- 05) Ink system\_L | Linear module 600mm cod. **81385W00**
- 05) Ceiling wall extruded pieces cod. **81426** + cable 5+1m cod. **81410**
- 06) T-connector cod. **81420**
- 07) Ink system\_L | Linear module 300mm cod. **81381W00**
- 08) Driver ON/OFF with cover 180 W cod. **81414**
- 09) Ink system\_SP | Projector cod. **81389W45**
- 10) L-connector cod. **81419**
- 11) Wall/ceiling cap cod. **81421**



# Stretching system on a staircase

## Location

Staircase with pointed arch. Along the walls, paintings of different sizes are arranged.

## Lighting solution

The beautiful pointed arch requires dedicated lighting that preserves its structure and at the same time emphasises it. The INK track follows the inclination of the staircase and the architecture, illuminating the ceiling and, indirectly, the entire environment. The track itself serves as a support cable for various projectors arranged in a row, directed toward one side and the other to illuminate the various paintings arranged along the walls. A space like the stairwell is exploited for the purpose, which becomes a true exhibition corridor.

**01)** Articulated wall mounting cod. **81423**

**02)** Ink system\_SP | Projector cod. **81389W30**

**03)** Cable 10+1m cod. **81411** + LED Strip Hi-Flux 5m cod. **81409W00**





03

02

01

# Wall/ceiling system in open-plan offices

## Location

Shared workspace in open space environment.

## Lighting solution

INK system allows the adoption of diversified lighting solutions while maintaining stylistic consistency. Above the table, the ceiling system acts as a hook for UGR controlled linear suspensions, perfect for situations that anticipate the intensive use of monitors and displays. Similar installation in the adjacent walkway area, with the same suspensions but different height from the ground, diffused optics and external driver with cover connected to the existing light point on the ceiling.

**01)** Wall/ceiling cap cod. **81421**

**02)** Ceiling wall extruded pieces cod. **81426** + cable 5+1m cod. **81410**

**03)** Ink system\_LP UGR | Linear suspension 1200mm cod. **81402W30**

**04)** Driver ON/OFF with cover 120 W cod. **81413**

**05)** Driver ON/OFF remote 120 W cod. **81416** + junction box cod. **81424**

**06)** Ink system\_LP UGR | Linear suspension anti-glaring 1200mm cod. **81404W30**







05

06



# Wall-mounted oriented stretching system

## Location

Generic minimalist environment, possible showroom or residential location. Light points specially designed for the installation of the INK track systems with remote power supply system.

## Lighting solution

The cross-configuration INK tracks illuminate and at the same time furnish an environment with an essential mood, exploiting the extreme stylistic cleanliness and the small number of furnishing accessories. The 90°-oriented track illuminates the wall thanks to the extremely wide emission of the high-flux LED strip.

**01)** Driver ON/OFF remote 120 W code **81416** + articulated wall mounting cod. **81423**

**02)** Cable 5+1m cod. **81410** + LED Strip Hi-Flux 2.5m cod. **81408W00**

**03)** Cable 10+1m cod. **81411** + LED Strip Hi-Flux 5m cod. **81409W00**



An Ear  
FINE WI  
THE BEST VINTAGES S  
NEW EDITION  
ART  
1000  
the BOOK of SYMBO  
Thames & Hudson

Ink system\_L | Linear module

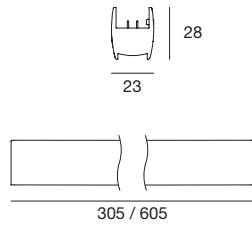
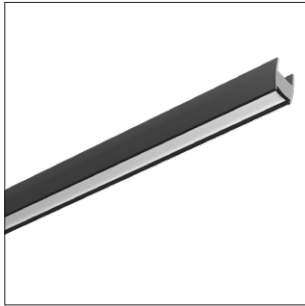

CRI 80 - 11 W 300 mm

Black	<b>81381</b>	3000 K	1155 lm	<b>W</b>	General	<b>00</b>
Black	An <b>81382</b>					

CRI 80 - 22 W 600 mm

Black	<b>81385</b>	3000 K	2310 lm	<b>W</b>	General	<b>00</b>
Black	An <b>81386</b>					



Ink systemL UGR | Anti-glaring linear module

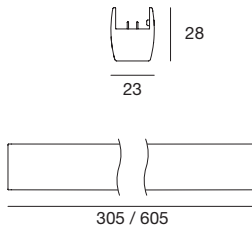
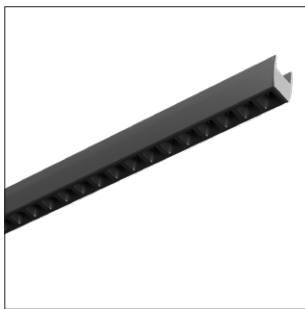

CRI 80 - 7 W 300 mm

Black	<b>81383</b>	3000 K	750 lm	<b>W</b>	Medium Flood	<b>30</b>
Black	An <b>81384</b>					

CRI 80 - 14 W 600 mm

Black	<b>81387</b>	3000 K	1500 lm	<b>W</b>	Medium Flood	<b>30</b>
Black	An <b>81388</b>					



Ink system\_SP | Projector

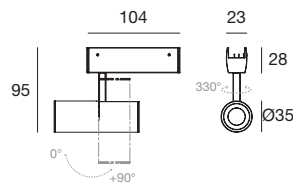

CRI 80 - 6 W

Black	<b>81389</b>	3000 K	780 lm	<b>W</b>	Spot	<b>10</b>
Black	An <b>81390</b>				Medium Flood	<b>30</b>
					Flood	<b>45</b>



Ink system\_P | Suspension

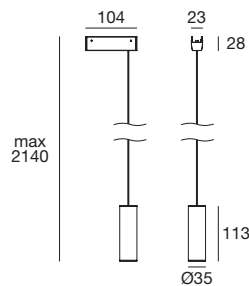
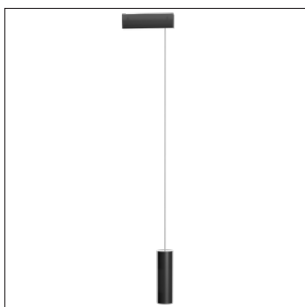

CRI 80 - 6 W

Black	<b>81395</b>	3000 K	780 lm	<b>W</b>	Flood	<b>45</b>
Black	An <b>81396</b>					



### Ink system\_LP | Linear suspension

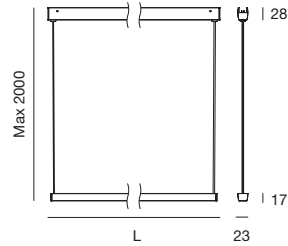
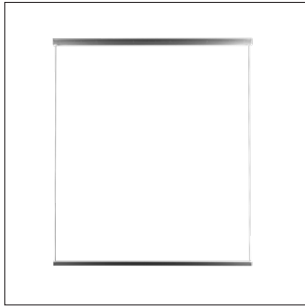

CRI 80 - 22 W 900 mm

Black	<b>81397</b>	3000 K	2311 lm	<b>W</b>	General	<b>00</b>
Black	An <b>81398</b>					

CRI 80 - 29 W 1200 mm

Black	<b>81402</b>	3000 K	3046 lm	<b>W</b>	General	<b>00</b>
Black	An <b>81403</b>					



### Ink system\_LP UGR | Anti-glaring linear suspension

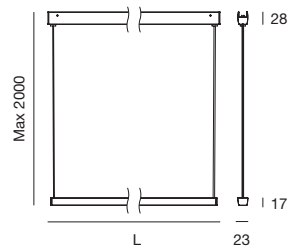
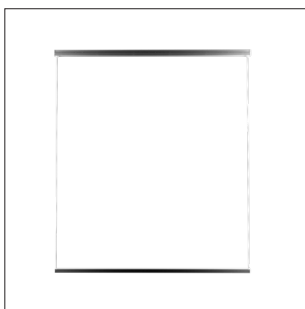

CRI 80 - 9 W 900 mm

Black	<b>81400</b>	3000 K	914 lm	<b>W</b>	Medium Flood	<b>30</b>
Black	An <b>81401</b>					

CRI 80 - 12 W 1200 mm

Black	<b>81404</b>	3000 K	1219 lm	<b>W</b>	Medium Flood	<b>30</b>
Black	An <b>81405</b>					



UGR<11

### Ink system\_Light units | LED Strips



CRI 85 - Basic 3,2 W/mt

1 m	<b>81428</b>	3000 K	449 lm	<b>W</b>	General	<b>00</b>
2,5 m	<b>81406</b>	3000 K	1123 lm	<b>W</b>		
5 m	<b>81407</b>	3000 K	2245 lm	<b>W</b>		

CRI 85 - Hi-Flux 12,6 W/mt

1 m	<b>81429</b>	3000 K	1677 lm	<b>W</b>	General	<b>00</b>
2,5 m	<b>81408</b>	3000 K	4193 lm	<b>W</b>		
5 m	<b>81409</b>	3000 K	8385 lm	<b>W</b>		



### Ink system\_Cable | Cable

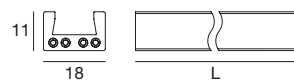

Black	5+1 m	<b>81410</b>
Black	10+1 m	<b>81411</b>

Ink system | ON/OFF driver with cover

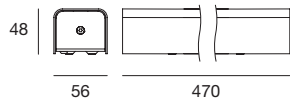

Black	120 W	<b>81413</b>
Black	180 W	<b>81414</b>

Ink system | Junction box

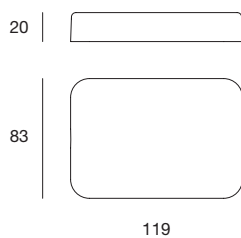

Black	<b>81424</b>
-------	--------------

Ink system | Remote ON/OFF driver

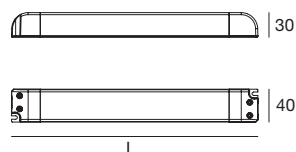

White	120 W	300 mm	<b>81416</b>
White	180 W	345 mm	<b>81417</b>

Ink system | Dimmable driver remote



**MAESTRO 2.0**  
p.982-984



Ink system | Cable cutter kit



**81427**

Ink system | Cross fitting

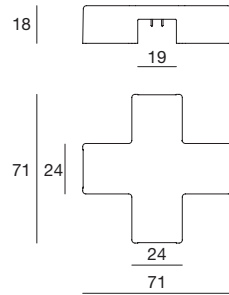
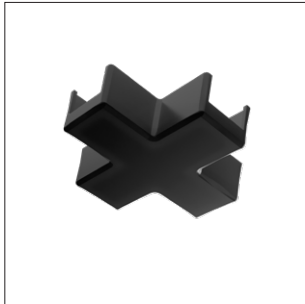

Black

81418

Ink system | L-shaped fitting

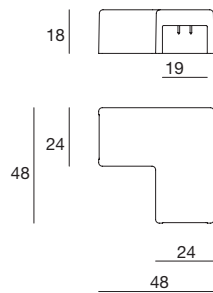
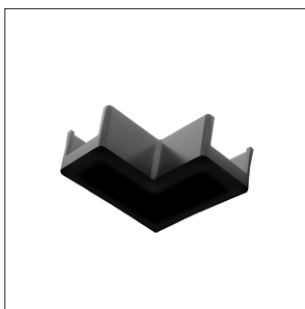

Black

81419

Ink system | T-shaped fitting

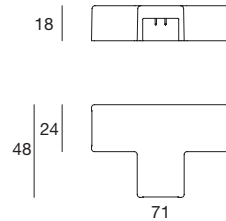
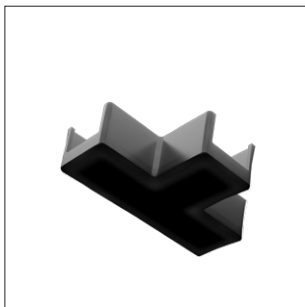

Black

81420

Ink system | Wall / ceiling sealing cap

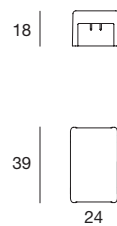
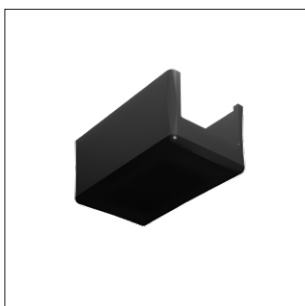

Black

81421

Ink system | Cardboard fixing

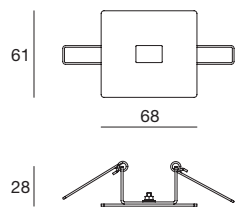
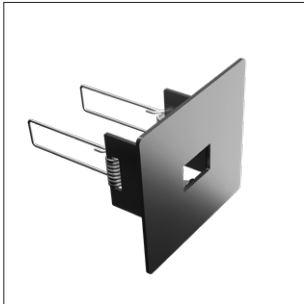

Black 2 x kit **81422**

Ink system | Swivel wall fixing

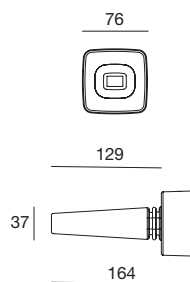

Black 2 x kit **81423**

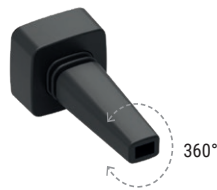

Ink system | Steel support and cable

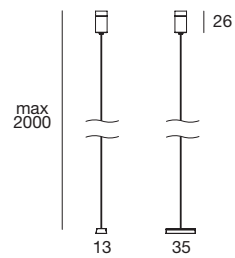
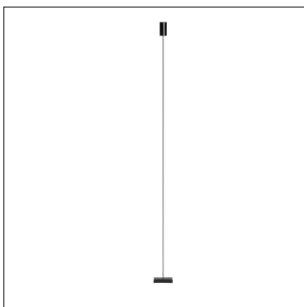

Black **81425**

Ink system | Wall / ceiling extruded

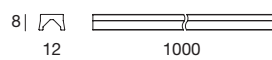

Black Kit 2 x **81430**

Black Kit 5 x **81426**



**Ink system\_P | Linear module**

Product code: 81386W00  
 Light Output Ratio: 39%  
 Source lumens: 2310 lm  
 Delivered lumens: 906 lm  
 Consumption: 22 W  
 Luminaire efficacy: 41 lm/W  
 Colour info: CCT 3000 K, CRI 80

Room height: 3 m  
 Cable height from the floor: 2 m

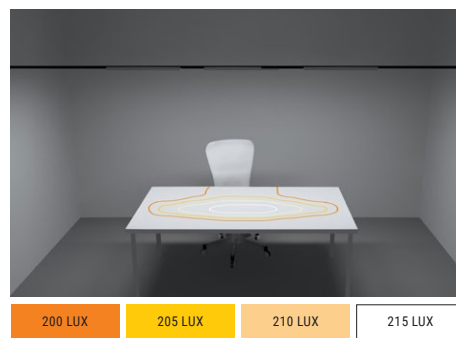
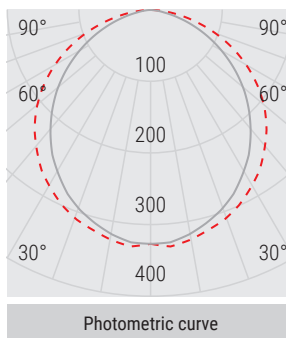

**Ink system\_LP UGR | Anti-glaring linear suspension**

Product code: 81400W30  
 Light Output Ratio: 36%  
 Source lumens: 914 lm  
 Delivered lumens: 331 lm  
 Consumption: 9 W  
 Luminaire efficacy: 36 lm/W  
 Colour info: CCT 3000 K, CRI 80

Room height: 3 m  
 Suspensions height from the floor: 1,80 m

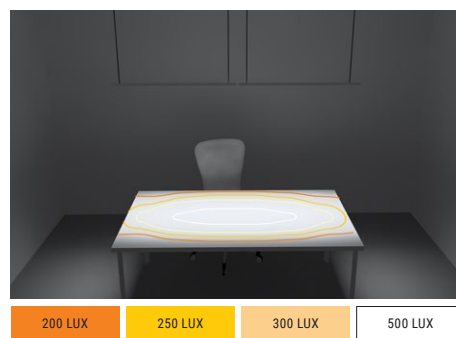
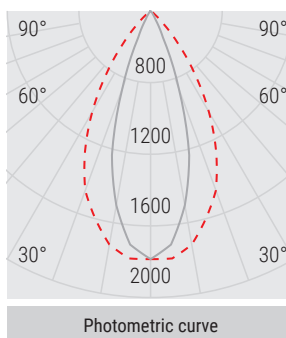

**Ink system\_SP | Projector**

Product code: 81389W45  
 Light Output Ratio: 66%  
 Source lumens: 780 lm  
 Delivered lumens: 521 lm  
 Consumption: 6 W  
 Luminaire efficacy: 86 lm/W  
 Colour info: CCT 3000 K, CRI 80

Room height: 3 m  
 Projector distance from the wall: 1,20 m

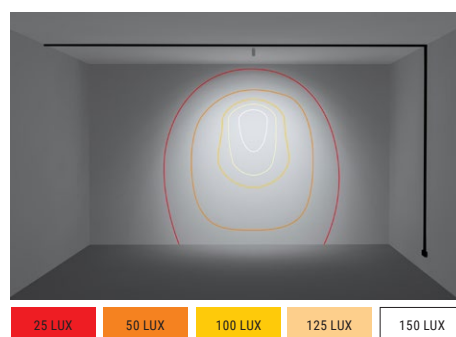
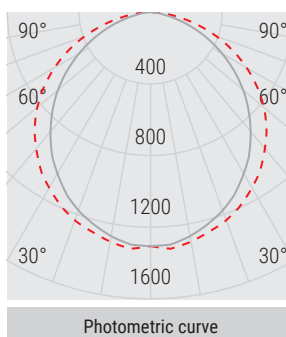

**Ink system\_light units | LED Strip**

Product code: 81409W00  
 Light Output Ratio: 77%  
 Source lumens: 8385 lm  
 Delivered lumens: 6495 lm  
 Consumption: 63 W  
 Luminaire efficacy: 103 lm/W  
 Colour info: CCT 3000 K, CRI 85

Room height: 3 m  
 Cable height from the floor: 2 m

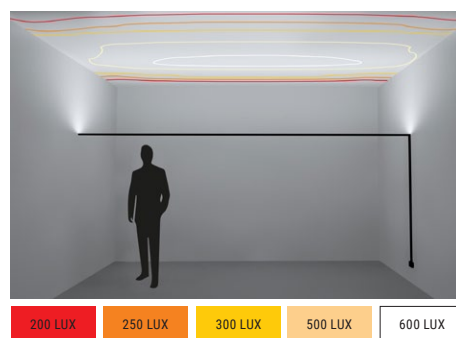
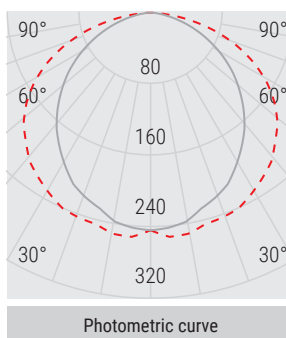

# linea light addresses

## Linea Light HQ Italy

via della Fornace, 59 z.i.  
31023 Castelfranco di Resana (TV) - Italy  
Phone: +39 0423 7868  
Fax: +39 0423 786900  
info@linealight.com

## LightVillage Milano

Exhibition Area Only  
via Morimondo, 26 int. 17G  
20143 Milano - Italy  
Phone: +39 02 36750915  
Fax: +39 02 36750915  
milano@lightvillage.it

## Linea Light Roma

Via Stendhal, 22  
00144 Roma - Italy  
Phone: +39 06 5935106  
info@linealightroma.com

## Linea Light UK

Suite 109 - Business Design Centre  
52 Upper Street - Islington N10QH  
London - UK  
Phone: +44 0203 6371983  
info@linealight-uk.com

## Linea Light France

Z.A. Heiden Est, 12 rue des Pays-Bas  
68310 Wittelsheim - France  
Phone: +33 389 75 52 23  
Fax: +33 389 75 59 07  
info@linealight.fr

## Linea Light Deutschland

Aktienstraße 214  
45473 Mülheim a.d. Ruhr - Germany  
Phone: +49 208 299979-0  
Fax: +49 208 299979-10  
service@linealight.de

## Linea Light Polska

ul. Wiosenna, 47  
41253 Czeladz - Poland  
Phone: +48 32 760 98 71  
Fax: +48 32 760 98 76  
biuro@linealight.com.pl

## Linea Light Russia

Luzhnetskaya nab., 2/4, str. 3, of. 304  
119270 Moscow - Russian Federation  
Phone: +7 495 639 99 41  
info@linealight.ru

## Linea Light Spain

C/ Longares, 48  
28022 Madrid - Spain  
Phone: +34 653 881 578  
info@linealighth.es

## Linea Light USA - Inter Lux

3741 Commerce Drive  
Suites 306-308  
Baltimore, MD 21227 - USA  
Phone: +1 410 381 1497  
Fax: +1 410 381 1589  
answers@inter-lux.com

## Linea Light GCC

Jumeirah Lake Towers  
JBC2 - 35th Floor Office 02 - Dubai - UAE  
P.O. Box 125902  
Phone: +971 4 4218275  
Fax: +971 4 4218274  
info@linealight.ae

## Linea Light Asia - Pacific

N.7 Nanyi Huayuan Road Industry Avenue  
528478 Xiaolan Town - Zhongshan City  
Guangdong Province - China  
Phone: +86 760 87618355  
Fax: +86 760 87553990  
info@linealight.cn

## Linea Light Singapore

21 Kaki Bukit Place, 5th Fl.  
Eunos Techpark Singapore  
416199 Singapore  
Phone: +65-6908 5758  
info.sg@linealight.com

## Art direction

Linea Light Group Marketing Dept.

## Product images

Velvet

## Location images

Imagine Computer Graphics

## Drawings

Andrea Boato

## Press & Prepress

Grafiche Italprint

## Printed in Italy

July 2019





**Your Light** | Future Proof